

EFFECTIVE JANUARY 1, 1988

PARTS LIST

HARRINGTON PEERLESS PUSH TROLLEY T3 SERIES 7.5T ~ 10T

CODE: PT

NOTE: Please Consult Factory For Prices

IMPORTANT

When ordering replacement parts, please specify the following points:

1. Trolley capacity.
2. Model number on name plate.
3. Correct part names and numbers.

HARRINGTON HOISTS

HARRINGTON

HARRINGTON CRANES

401 WEST END AVENUE, MANHEIM, PA 17545

PHONE (AREA 717) 665-2000
FAX 717-665-2861

FOR MANUAL HOIST 7.5T ~ 10T

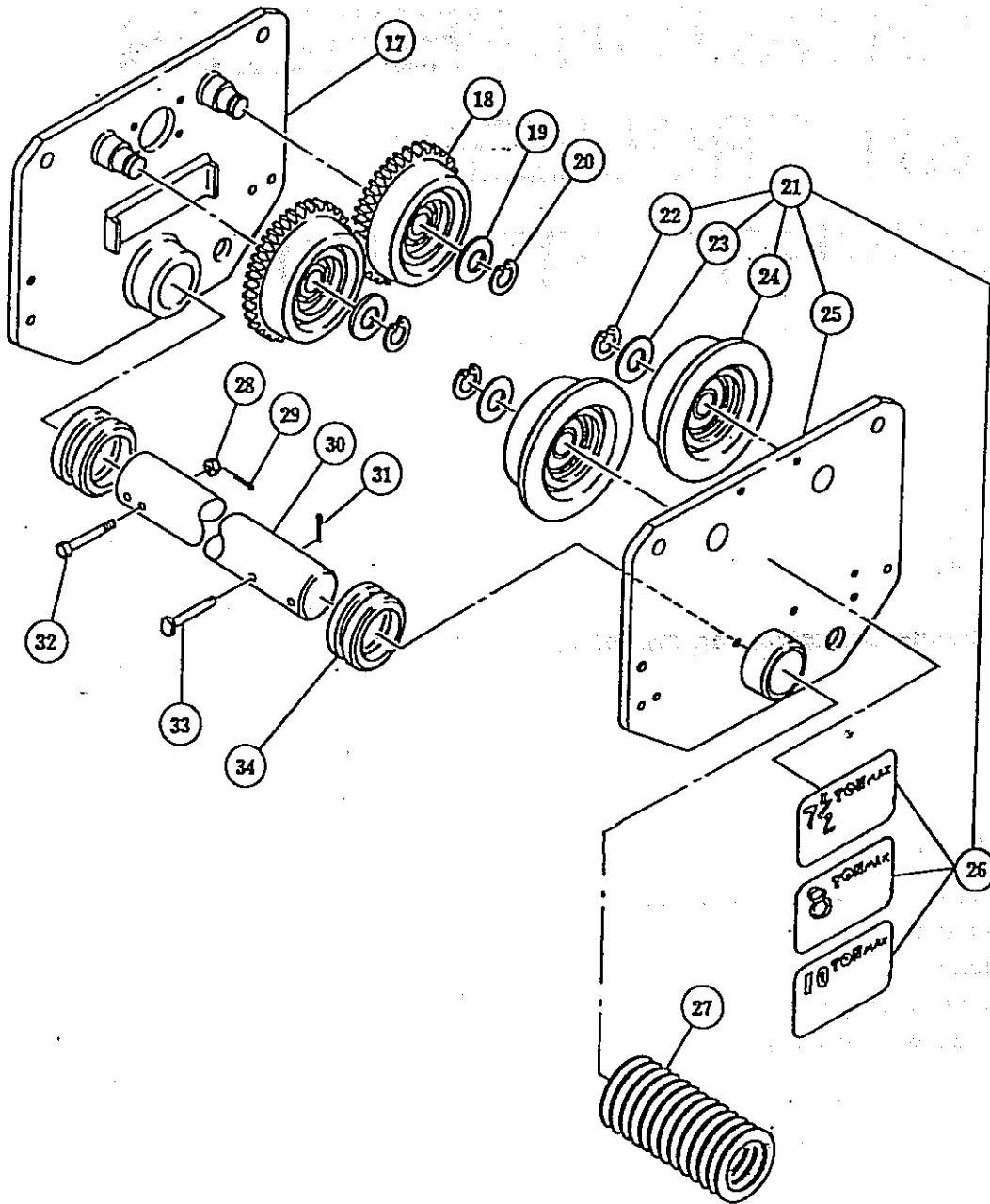

FOR MANUAL HOIST 7.5T ~ 10T

Fig No	Part No	Part Name	Nos per Trolley		
			7.5 ^T	8 ^T	10 ^T
17	T3G5111	Side Plate G Assembly	1	1	1
18	T3G1101	Track Wheel G Assembly	2	2	2
19	T3G104	Washer	4	4	4
20	T3G106	Snap Ring	4	4	4
21	T3G1110	Side Plate B Complete Set	1	1	1
22	T3G106	Snap Ring	4	4	4
23	T3G104	Washer	4	4	4
24	T3G1102	Track Wheel P Assembly	2	2	2
25	T3G5110	Side Plate B Assembly	1	1	1
26	T3G801	Name Plate B	1	1	1
27	MS116	Adjusting Spacer	15	15	15
28	T3G154	Slotted Nut	1	1	1
29	T3G155	Split Pin	1	1	1
30	MS115	Suspension Shaft	1	1	1
31	T3G157	Split Pin	1	1	1
32	MS161	Bolt	1	1	1
33	MS164	Shaft Stopper Pin	1	1	1
34	MS117	Fixing Spacer	4	4	4

OPTIONAL PARTS FOR ELECTRIC HOIST ES 7.5T ~ 8 T

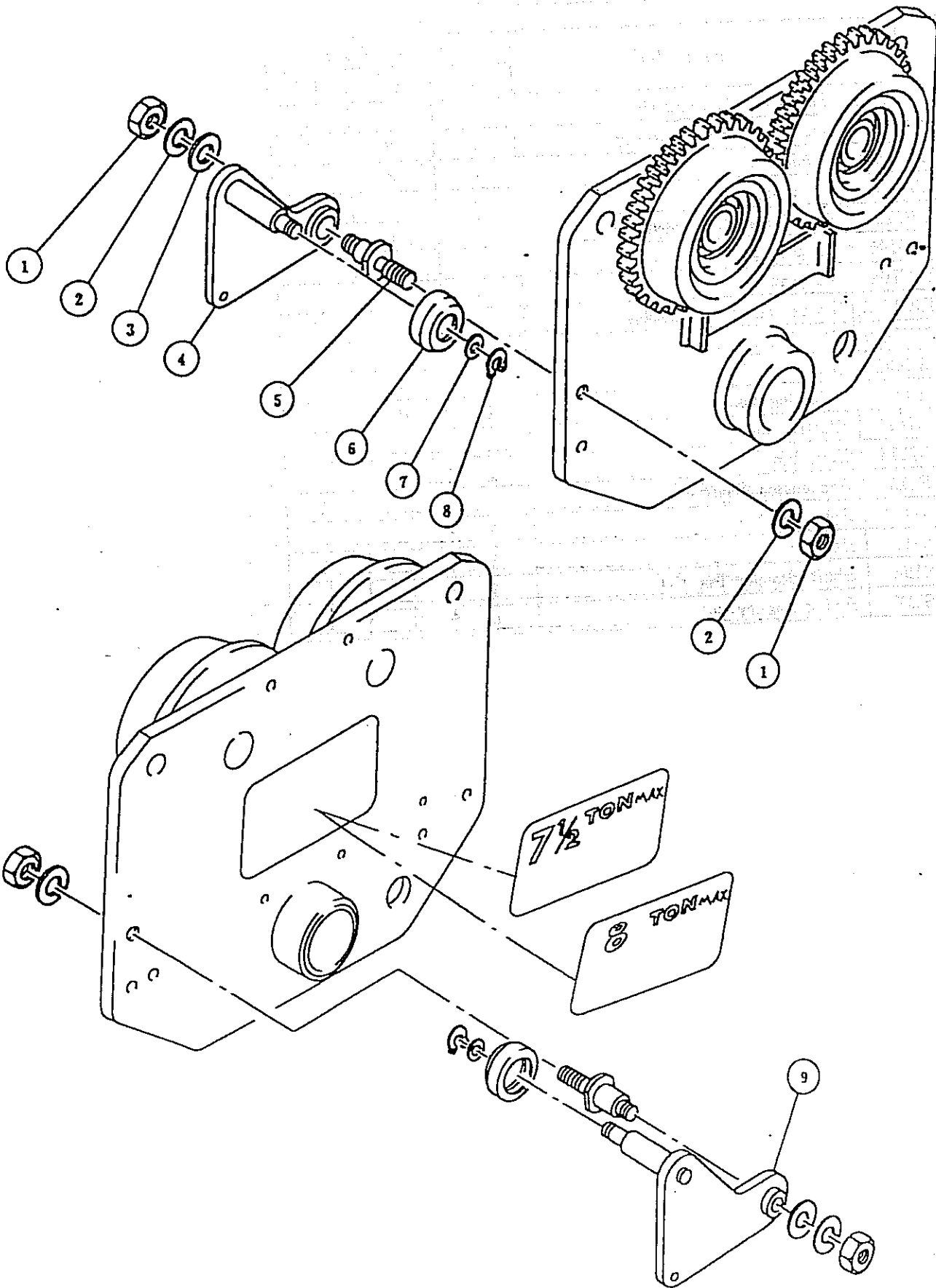

FOR ELECTRIC HOIST ES 7.5T ~ 10 T

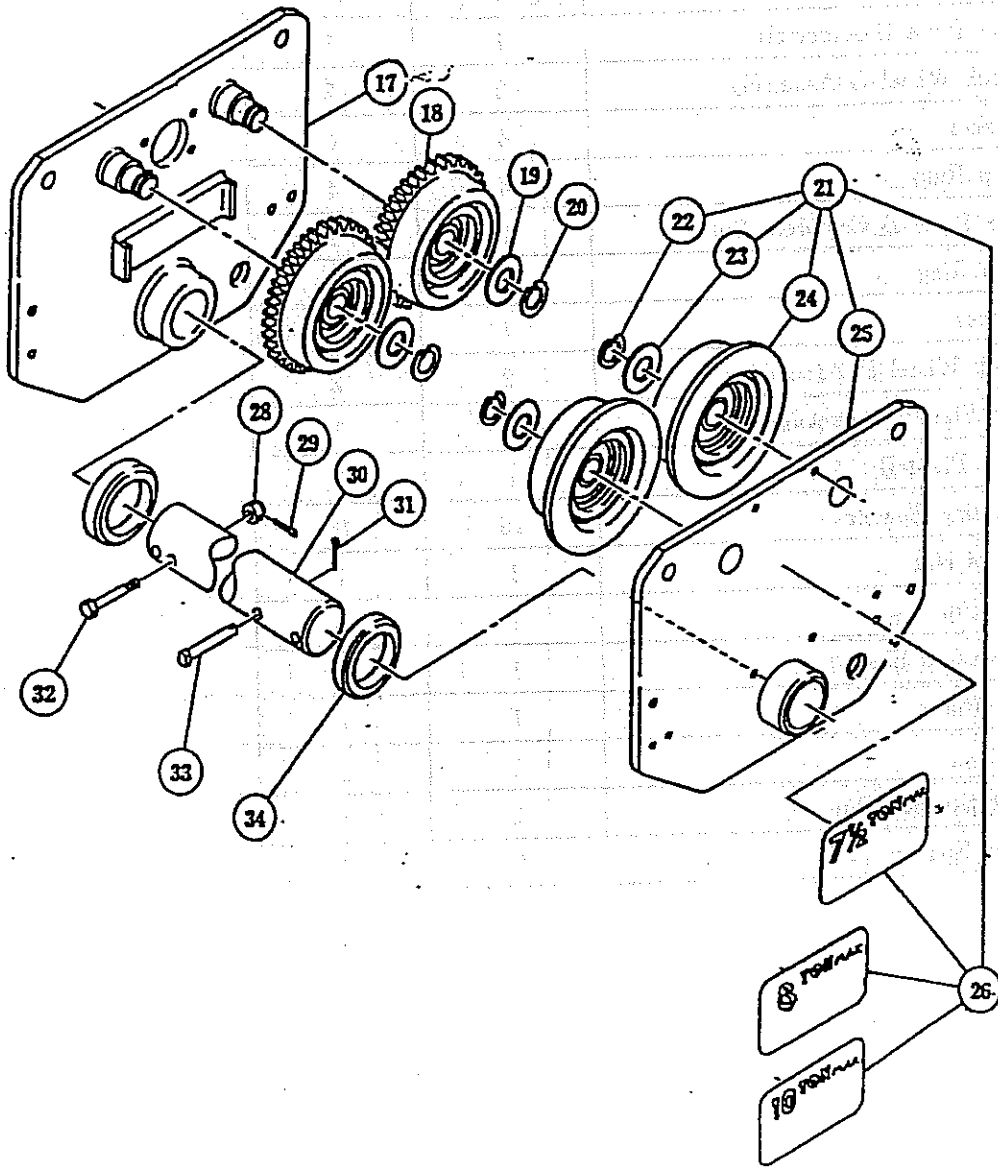

PARTS FOR ELECTRIC HOIST ES 7.5T ~ 10 T

Fig No	Part No	Part Name	Nos per Trolley		
			7.5 ^T	8 ^T	10 ^T
17	T3G5111	Side Plate G Assembly	1		1
18	T3G1101	Track Wheel G Assembly	2		2
19	T3G104	Washer	4		4
20	T3G106	Snap Ring	4		4
21	T3G1110	Side Plate B Complete Set	1		1
22	T3G106	Snap Ring	4		4
23	T3G104	Washer	4		4
24	T3G1102	Track Wheel P Assembly	2		2
25	T3G5110	Side Plate B Assembly	1		1
26	T3G801	Name Plate B	1		1
27	MS116	Adjusting Spacer	15		15
28	T3G154	Slotted Nut	1		1
29	T3G155	Split Pin	1		1
30	MS115	Suspension Shaft	1		1
31	T3G157	Split Pin	1		1
32	MS161	Bolt	1		1
33	MS164	Shaft Stopper Pin	1		1
34	MS117	Fixing Spacer	2		2

OPTIONAL PARTS FOR ELECTRIC HOIST ES 7.5T ~ 8T

Fig No	Part No	Part Name	Nos per Trolley	Capacity
1	MS411	Nut	4	
2	MS413	Spring Washer	4	
3	MS412	Washer	2	
4	MS5401	Hunger Plate A Assembly	1	
5	MS408	Bolt	2	
6	MS1405	Hunger Wheel Assembly	2	
7	MS407	Wheel Washer	2	
8	MS415	Snap Ring	2	
9	MS5402	Hunger Plate B Assembly	1	

CONFIDENTIAL - SECURITY INFORMATION

[Faint, mostly illegible text, possibly a list or report content]

